

MARCOS DE NIZA PLAZA

TEMPE • ARIZONA



705 East Guadalupe Road • Tempe, Arizona 85283

For further information, please contact:

Michael A. Pollack
(480) 888-0888

Size: 66,600 Square Feet **Spaces Starting From:** 1,200 Sq. Ft.

Zoning: C-2, City of Tempe

Traffic Counts: Corner Total: 51,376
Guadalupe Rd: 21,981 cars/day • Rural Road: 29,395 cars/day
(2009: City of Tempe)

Demographics:

(2010: Applied Geographic Solutions / TIGER Geography)

	1 mile radius	3 mile radius	5 mile radius
Population:	13,830	124,220	369,787
Households:	5,266	45,747	136,083
Median Household Income:	\$ 70,579	\$ 68,677	\$ 60,372
Median Age:	36	34	32

For leasing plans, availability and rates, visit us at:

www.pollackinvestments.com/marcos



The information contained herein are estimates obtained from sources we deem reliable. While we have no reason to doubt its accuracy, we do not guarantee it.

Michael A. Pollack
REAL ESTATE INVESTMENTS

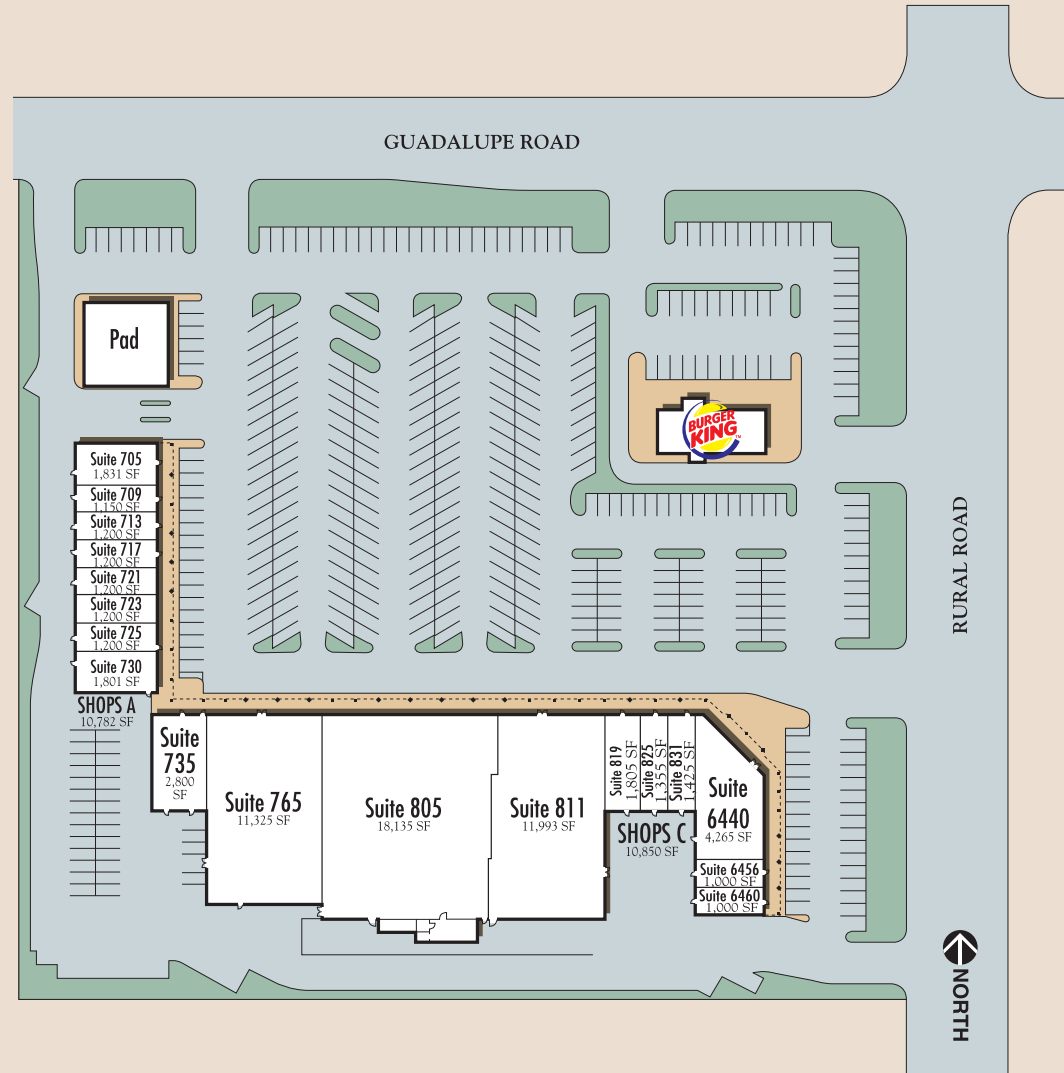

For further information, please contact:
Michael A. Pollack
 (480) 888-0888

Michael A. Pollack
REAL ESTATE INVESTMENTS

* Square foot indications are approximate

1136 West Baseline Road • Mesa, Arizona 85210 • (480) 888-0888 • fax (480) 814-7741 • www.pollackinvestments.com