

ALMA RAY CENTRAL CENTER

C H A N D L E R • A R I Z O N A



961 West Ray Road • Chandler, Arizona 85225

For further information, please contact:

Michael A. Pollack
(480) 888-0888

Size: 14,694 Square Feet **Spaces Starting From:** 697 Sq. Ft.

Zoning: C-2, City of Chandler

Traffic Counts: Corner Total: 30,500
Alma School Rd.: 15,600 cars/day • Ray Rd.: 14,900 cars/day
(2010: City of Chandler)

Demographics:

(2010: Applied Geographic Solutions / TIGER Geography)

	1 mile radius	3 mile radius	5 mile radius
Population:	19,911	158,204	350,360
Households:	6,442	52,173	115,666
Median Household Income:	\$ 57,442	\$ 65,796	\$ 72,370
Median Age:	31.5	31.5	32.2

For leasing plans, availability and rates, visit us at:

www.pollackinvestments.com/almaray

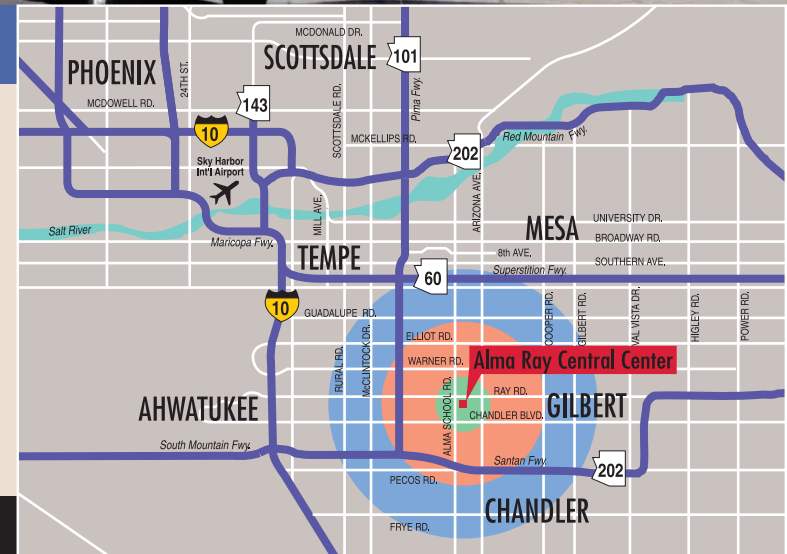

Michael A. Pollack
REAL ESTATE INVESTMENTS

The information contained herein are estimates obtained from sources we deem reliable. While we have no reason to doubt its accuracy, we do not guarantee it.

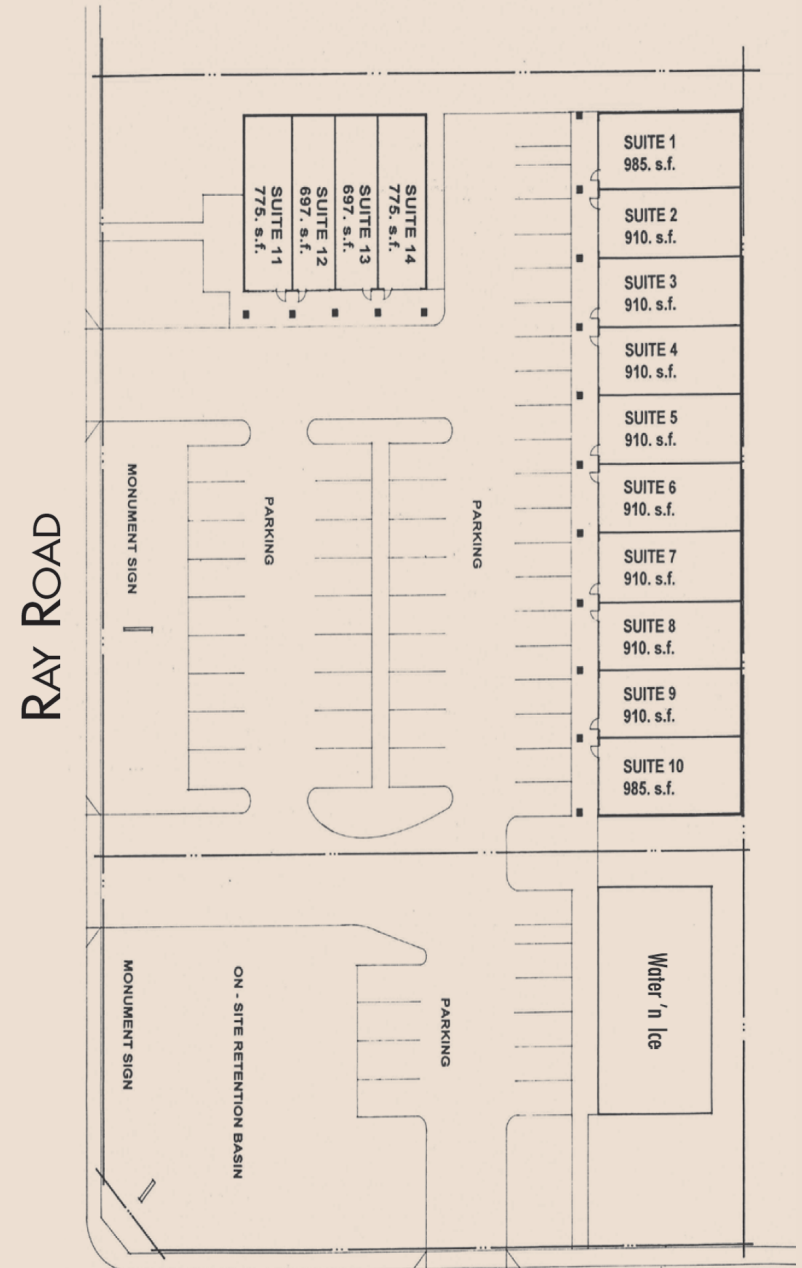

ALMA SCHOOL ROAD

For further information, please contact:

Michael A. Pollack
(480) 888-0888

Michael A. Pollack
REAL ESTATE INVESTMENTS

* Square foot indications are approximate

1136 West Baseline Road • Mesa, Arizona 85210 • (480) 888-0888 • fax (480) 814-7741 • www.pollackinvestments.com