

# WESTVIEW PLAZA

## LEASING PLAN

NEC N. 75th AVE. & THOMAS RD.  
2929 N. 75th AVE., PHOENIX, AZ 85033

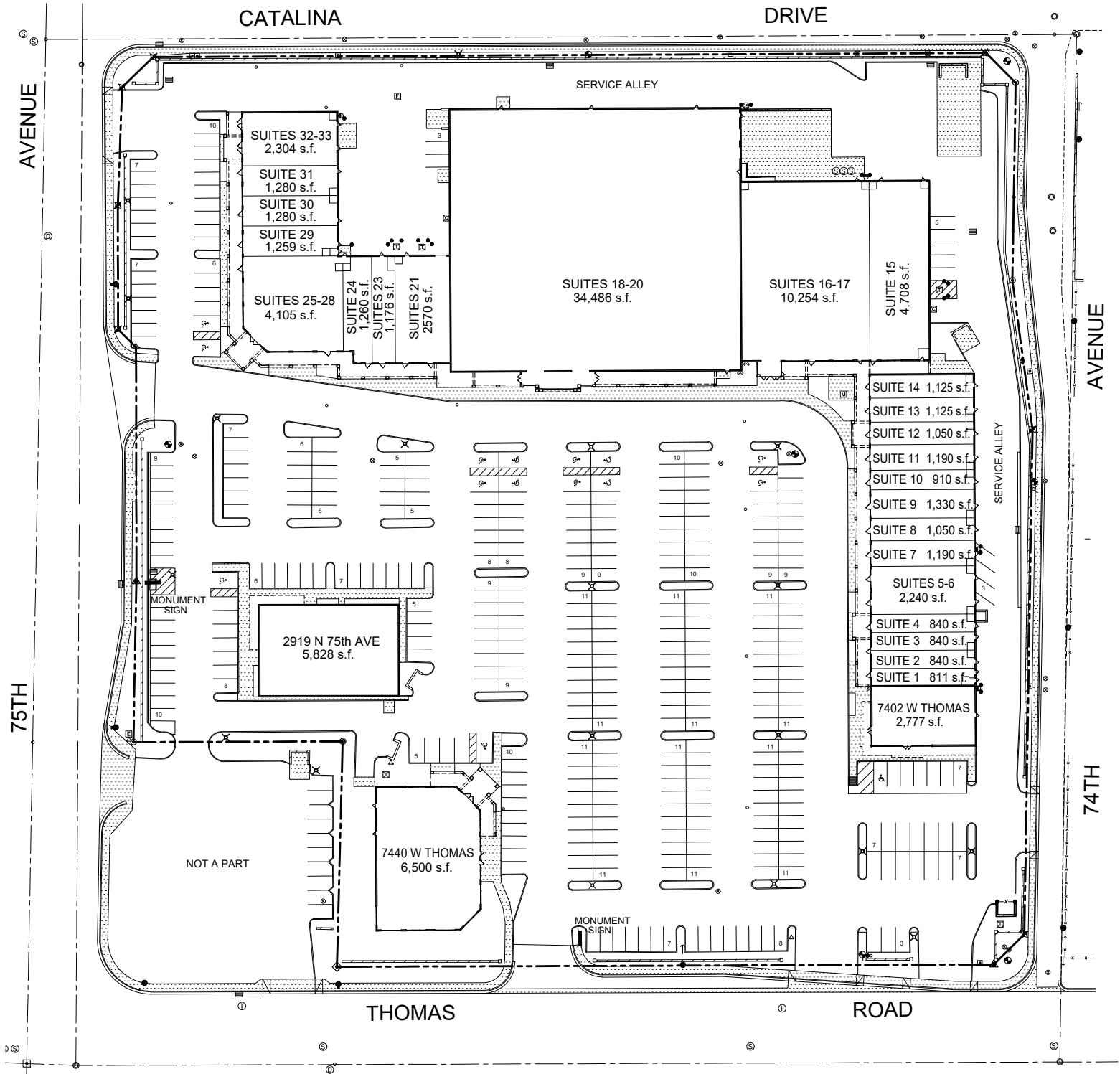

NORTH

This center has approximately 94,328 s.f. and approximately 418 parking spaces. Any plan or exhibit attached to this property is intended to show only the general layout of the property or part thereof. Landlord reserves the right to alter, add to or omit in whole or in part the structures and/or common areas currently existing or hereafter constructed on the property or shown on any plan. The property is subject to change or modification as may be made by the landlord in its sole discretion or required by any authority having jurisdiction. Any and all measurements, distances or square footage are approximate. Landlord does not covenant or represent that any occupant currently or hereafter located at the property will remain a tenant. Landlord makes no representations, either expressed or implied as to the current or future addition or subtraction of tenants and/or occupancy of the property or any surrounding properties. 06.8.16 (14-87)